

# Lospa

K N E E   S Y S T E M

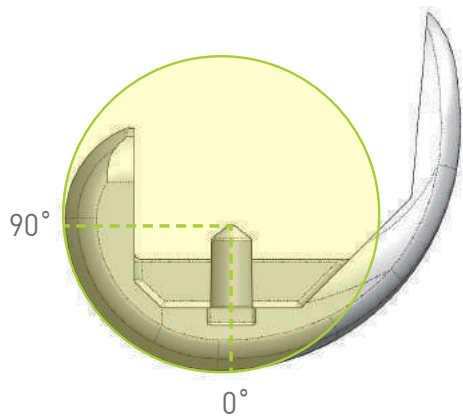

# Femoral Component



Single axis concept for articular stability with flexion and improving range of motion.

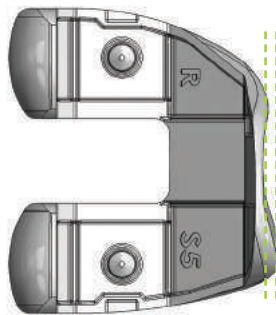
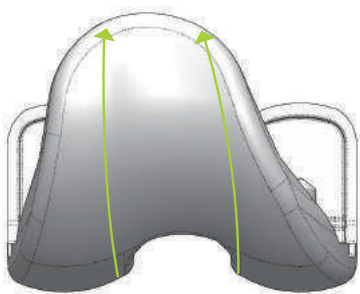

(CR Version)

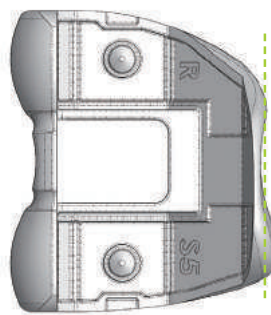

(PS Version)

Anterior flange shape and dimension for the optimal patella tracking.

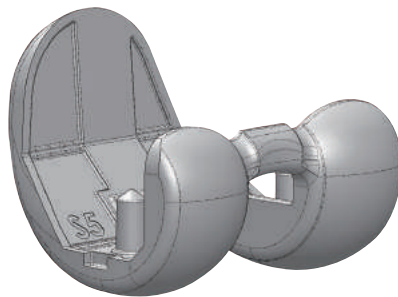

Intercondylar cam design of PS type for reducing the risk of dislocation in deep flexion.

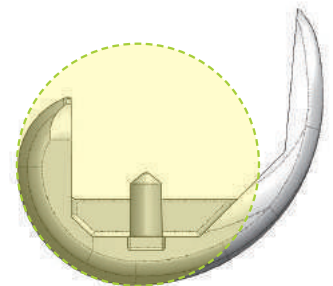
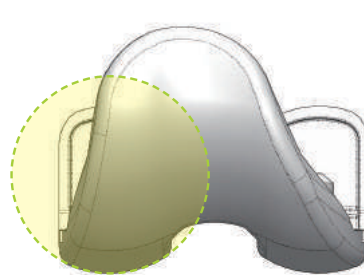

Sphere-shaped articular surface for reducing contact stress and improving stability.

# Tibial Insert Fixed Type

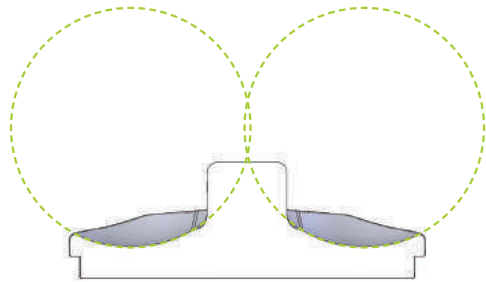

Curved on Curved



High conformity at the frontal plane to improve contact area

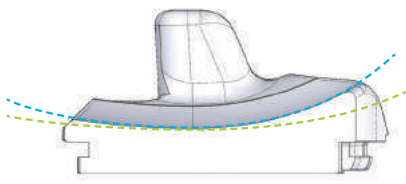

Anterior tibial articular surface :  
for joint stability

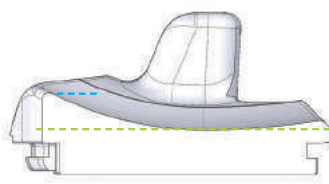

Posterior tibial articular surface :  
for joint function (deep flexion)



Double radius at the sagittal plane for improved anterior stability and deep flexion.

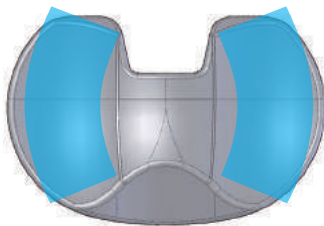

Rotated track  
(CR Version)

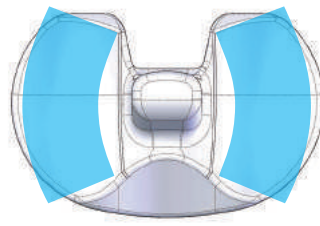

Rotated track  
(PS Version)



Rotated articular surface considering axial rotation of the femoral component

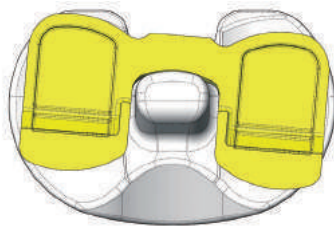

Rotation

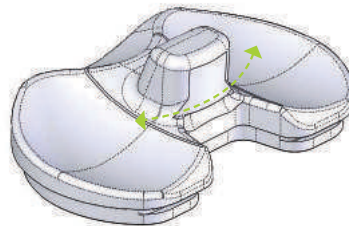

Rounded tibial post to reduce edge loading in the PS type (in the case of PS type)

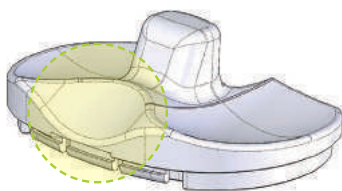

Improved anterior relief for deep flexion



# Tibial Baseplate

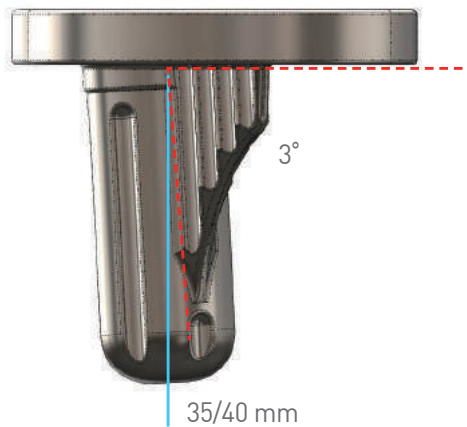

Stem with keel for improving initial implant stability.

Stem with posterior slope aiding in reducing the anterior cortex impingement.

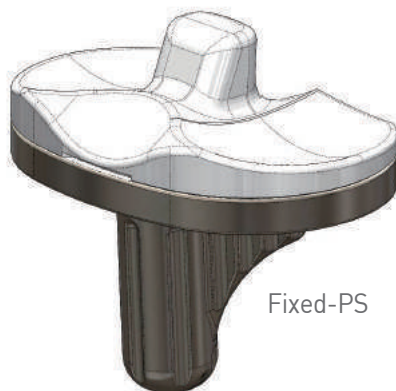

Commonality of tibial baseplate: CR/PS in fixed type.

# Patellar Component

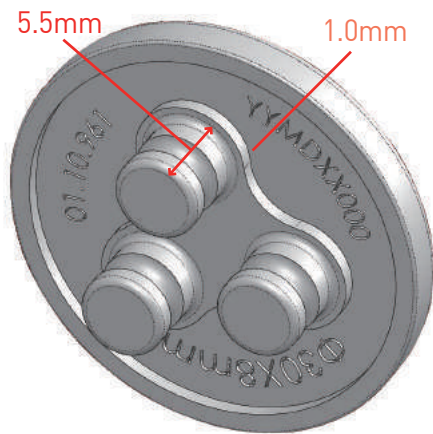

## Cement pockets:

Cement pockets provide optimal condition for cemented fixation.

There is cement pocket which has 1.0mm depth, but which is not deep enough to compromise the strength of the component. There is reinforcement in the center of these pocket and the peripheral rim is maintained with 1.5mm thickness.

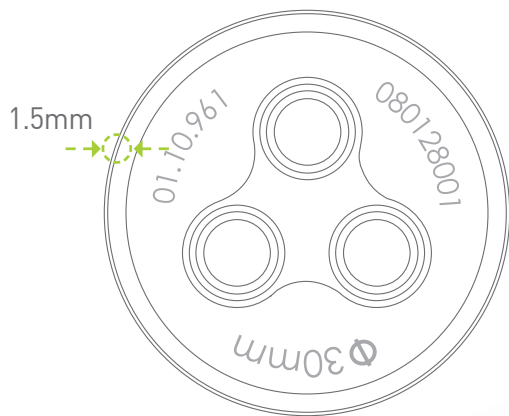

# Size Combination Chart

## Fixed bearing couple

Tibial inserts	Femoral components								
	F3 51AP/59ML	F4 54AP/62ML	F5 57AP/65ML	*F6 60AP/65ML	F7 60AP/68ML	*F8 63AP/68ML	F9 63AP/71ML	F11 66AP/74ML	*F12 69AP/74ML
T13 40AP/61ML	●								
T14 42AP/64ML	●	●							
T15 44AP/67ML		●	●						
*T6 45AP/70ML				●	●				
T17 46AP/72ML				●	●				
*T18 48AP/72ML						●	●		
T19 48AP/74ML						●	●		
T111 50AP/76ML								●	
*T112 52AP/81ML									●

\* Special order

## Size Combination Chart : Fixed type

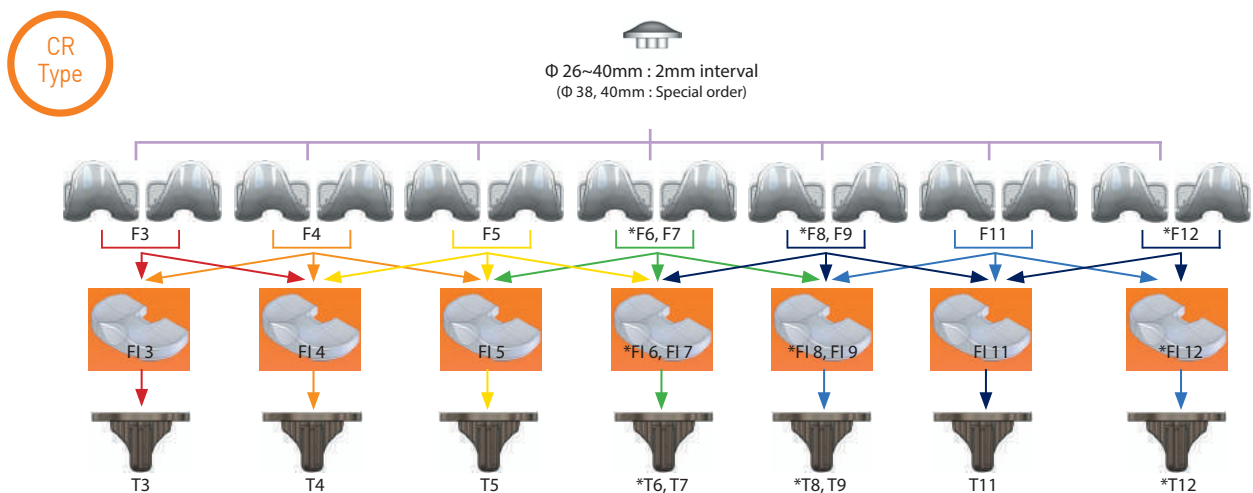
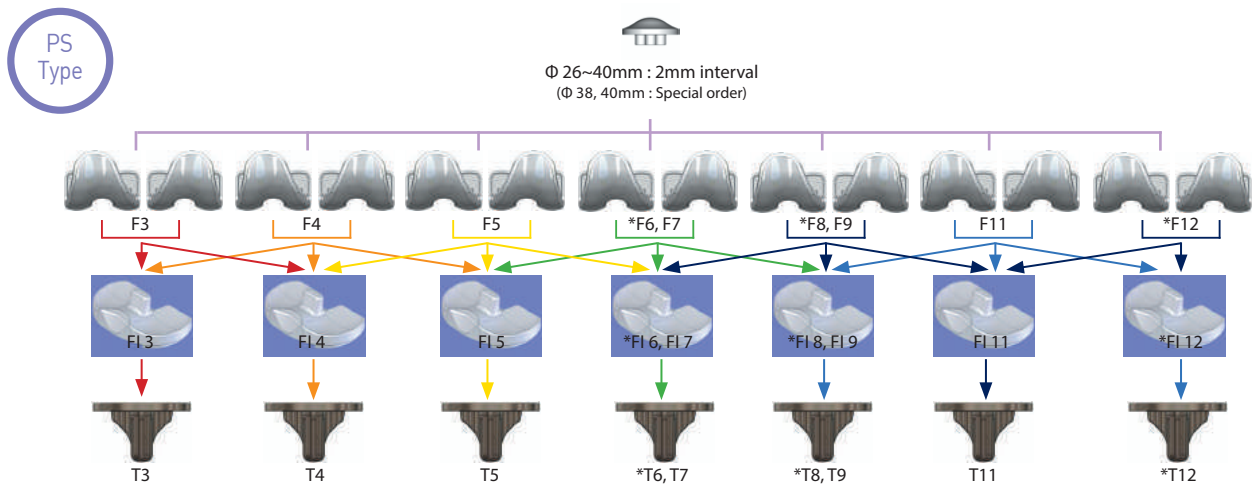

\* Special order

# Implant Ordering Information

## Lospa Femoral Component (CR)

Part No.		Size	AP/ML (mm)
Left	Right		
01.10.003	01.10.023	3	51/59
01.10.004	01.10.024	4	54/62
01.10.005	01.10.025	5	57/65
01.10.006	01.10.026	6*	60/65
01.10.007	01.10.027	7	60/68
01.10.008	01.10.028	8*	63/68
01.10.009	01.10.029	9	63/71
01.10.00B	01.10.02B	11	66/74
01.10.00C	01.10.02C	12*	69/74

## Lospa Femoral Component (PS)

Part No.		Size	AP/ML (mm)
Left	Right		
01.10.043	01.10.063	3	51/59
01.10.044	01.10.064	4	54/62
01.10.045	01.10.065	5	57/65
01.10.046	01.10.066	6*	60/65
01.10.047	01.10.067	7	60/68
01.10.048	01.10.068	8*	63/68
01.10.049	01.10.069	9	63/71
01.10.04B	01.10.06B	11	66/74
01.10.04C	01.10.06C	12*	69/74

## Lospa Tibial Baseplate

Part No.	Size	L (mm)	AP/ML (mm)
01.10.503	3	35	40/61
01.10.504	4		42/64
01.10.505	5		44/67
01.10.506	6*		45/70
01.10.507	7		46/72
01.10.508	8*	40	48/72
01.10.509	9		48/74
01.10.50B	11		50/76
01.10.50C	12*		52/81

## Lospa Patellar Component (Dome)

Part No.	Size (mm)	Thickness (T) (mm)
01.10.921	26	8
01.10.941	28	8
01.10.961	30	8
01.10.981	32	8
01.10.9A2	34	9
01.10.9C3	36	10
01.10.9EC	38	10*
01.10.9GC	40	10*

## Lospa Tibial Insert (CR)

Part No.	Size	T (mm)	AP/ML (mm)
01.10.132	3	10	40/61
01.10.134		12	
01.10.136		14	
01.10.138		16	
01.10.13A		18	
01.10.13C		20	
01.10.13E		22*	
01.10.13G	24*		
01.10.13I	26*	4	42/64
01.10.142	10		
01.10.144	12		
01.10.146	14		
01.10.148	16		
01.10.14A	18		
01.10.14C	20		
01.10.14E	22*		
01.10.14G	24*		
01.10.14I	26*	5	44/67
01.10.152	10		
01.10.154	12		
01.10.156	14		
01.10.158	16		
01.10.15A	18		
01.10.15C	20		
01.10.15E	22*		
01.10.15G	24*		
01.10.15I	26*	6*	45/70
01.10.162	10		
01.10.164	12		
01.10.166	14		
01.10.168	16		
01.10.16A	18		
01.10.16C	20		
01.10.16E	22*		
01.10.16G	24*		
01.10.16I	26*	7	46/72
01.10.172	10		
01.10.174	12		
01.10.176	14		
01.10.178	16		
01.10.17A	18		
01.10.17C	20		
01.10.17E	22*		
01.10.17G	24*		
01.10.17I	26*	8*	48/72
01.10.182	10		
01.10.184	12		
01.10.186	14		
01.10.188	16		
01.10.18A	18		
01.10.18C	20		
01.10.18E	22*		
01.10.18G	24*		
01.10.18I	26*	9	48/74
01.10.192	10		
01.10.194	12		
01.10.196	14		
01.10.198	16		
01.10.19A	18		
01.10.19C	20		
01.10.19E	22*		
01.10.19G	24*		
01.10.19I	26*	11	50/76
01.10.1B2	10		
01.10.1B4	12		
01.10.1B6	14		
01.10.1B8	16		
01.10.1BA	18		
01.10.1BC	20		
01.10.1BE	22*		
01.10.1BG	24*		
01.10.1BI	26*		

Part No.	Size	T (mm)	AP/ML (mm)
01.10.1C2	12*	10	52/81
01.10.1C4		12	
01.10.1C6		14	
01.10.1C8		16	
01.10.1CA		18	
01.10.1CC		20	
01.10.1CE		22*	
01.10.1CG		24*	
01.10.1CI		26*	

## Lospa Tibial Insert (PS)

Part No.	Size	T (mm)	AP/ML (mm)
01.10.232	3	10	40/61
01.10.234		12	
01.10.236		14	
01.10.238		16	
01.10.23A		18	
01.10.23C		20	
01.10.23E		22*	
01.10.23G		24*	
01.10.23I		26*	
01.10.242		4	
01.10.244	12		
01.10.246	14		
01.10.248	16		
01.10.24A	18		
01.10.24C	20		
01.10.24E	22*		
01.10.24G	24*		
01.10.24I	26*		
01.10.252	5		10
01.10.254		12	
01.10.256		14	
01.10.258		16	
01.10.25A		18	
01.10.25C		20	
01.10.25E		22*	
01.10.25G		24*	
01.10.25I		26*	
01.10.262		6*	10
01.10.264	12		
01.10.266	14		
01.10.268	16		
01.10.26A	18		
01.10.26C	20		
01.10.26E	22*		
01.10.26G	24*		
01.10.26I	26*		
01.10.272	7		10
01.10.274		12	
01.10.276		14	
01.10.278		16	
01.10.27A		18	
01.10.27C		20	
01.10.27E		22*	
01.10.27G		24*	
01.10.27I		26*	

\* : Special order

Part No.	Size	T (mm)	AP/ML (mm)
01.10.282	8*	10	48/72
01.10.284		12	
01.10.286		14	
01.10.288		16	
01.10.28A		18	
01.10.28C		20	
01.10.28E		22*	
01.10.28G	24*		
01.10.28I	26*	9	48/74
01.10.292	10		
01.10.294	12		
01.10.296	14		
01.10.298	16		
01.10.29A	18		
01.10.29C	20		
01.10.29E	22*		
01.10.29G	24*		
01.10.29I	26*	11	50/76
01.10.2B2	10		
01.10.2B4	12		
01.10.2B6	14		
01.10.2B8	16		
01.10.2BA	18		
01.10.2BC	20		
01.10.2BE	22*		
01.10.2BG	24*		
01.10.2BI	26*	12*	52/81
01.10.2C2	10		
01.10.2C4	12		
01.10.2C6	14		
01.10.2C8	16		
01.10.2CA	18		
01.10.2CC	20		
01.10.2CE	22*		
01.10.2CG	24*		
01.10.2CI	26*		



**Manufacturing Plant** 12, Yeongsanhong 1-gil, Ijang-myeon, Seobuk-gu, Cheonan-si, Chungcheongnam-do, Korea | TEL 82-41-585-7114 | FAX 82-41-585-7113  
**Seoul Office** 483, Gangnam-daero, Seocho-gu, Seoul, Korea | TEL 82-2-3445-5492~5 | FAX 82-2-3445-5467,5497

**Corentec America** 17305 Von Karman Ave. Suite 114, Irvine, CA 92614, USA | TEL 1-949-379-6227 | FAX 1-949-387-5716

**EC Representative : Emergo Europe** Molenstraat 15, 2513 BH, The Hague, The Netherlands | TEL 31-70-345-8570 | FAX 31-70-346-7299

[www.corentec.com](http://www.corentec.com)

Distributor